

OPERATOR'S MANUAL

INCLUDING: OPERATION, INSTALLATION & MAINTENANCE

254XX-X

264XX-X

274XX-X

RELEASED: 7-29-83

REVISED: 3-29-95

(REV.C) ASC

SUPER-DUTY AIR LINE F-R-L 1-1/4" & 1-1/2" PIPE SIZES



**READ THIS MANUAL CAREFULLY BEFORE INSTALLING,
OPERATING OR SERVICING THIS EQUIPMENT.**

OPERATING AND SAFETY PRECAUTIONS

- These units are intended for use in industrial compressed air systems only. They must not be used where pressure or temperature may exceed maximum rated operating conditions. See specifications.
- In Lubrication applications, some oil mist may escape from the point of use into the surrounding atmosphere. Users are referred to OSHA safety and health standards for limiting oil mist contamination and utilization of protecting equipment.
- Sightfeed dome on lubricator can be damaged if exposed to such substances as certain solvents, strong alkalis, compressor oils containing ester-based additives, or synthetic oils. Fumes of these substances externally or internally, can also result in damage. Clean with warm water only. Before using with fluids other than air, for non-industrial applications, or for life support systems consult the Aro Corporation, Bryan, Ohio 43506.
- Secondary pressure adjustment ranges are not minimum or maximum secondary pressure limits. Regulators can be adjusted to zero PSIG secondary pressure and, generally, to pressures in excess of those specified. The use of these regulators to control pressure outside of the specified ranges is not recommended.
- The accuracy of the indication of pressure gauges can change, both during shipment (despite care in packaging) and during the service life. If a pressure gauge is to be used with these products and if inaccurate indications may be hazardous to personnel or property, the gauge should be calibrated before initial installation and at regular intervals during use. For gauge standards refer to ANSI B40.1-1974.
- In regulation applications, an outlet pressure in excess of the regulator pressure setting could cause downstream equipment to rupture or malfunction, install a pressure relief device downstream of the regulator. The relief pressure and flow capacity of the relief device must satisfy system requirements.
- Shut-off and relieve air supply before disassembling the unit.
- Periodically, the filter element and lubricator bowls should be removed and cleaned.

254XX-XXX FILTER

PRIMARY PRESSURE

250 PSI MAX. (17.2 BAR MAX.)

TEMPERATURE RANGE

0° F to 175° F (-18° C to 79° C)

REPAIR KITS

- 104119 STANDARD FILTER ELEMENT (50 MICRON)
- 104225 OPTIONAL FILTER ELEMENT (25 MICRON)
- ✓ 104116 REPAIR KIT
- 104163 SIGHT GLASS KIT
- 104212 DRAIN KIT

INSTALLATION

Install filter upstream from regulator and lubricator and as close as possible to the tool, cylinder, or pneumatic device. The filter must be installed with the air flow through the unit in the direction as indicated by the arrow on the base.

ACCESSORIES

104115 U-BOLT MTG. BRACKET KIT
(INCLUDES (2) "L" BRACKETS & (2) U-BOLTS)

104068 AUTOMATIC DRAIN
(REPLACES MANUAL DRAIN ASM. IN BOWL)

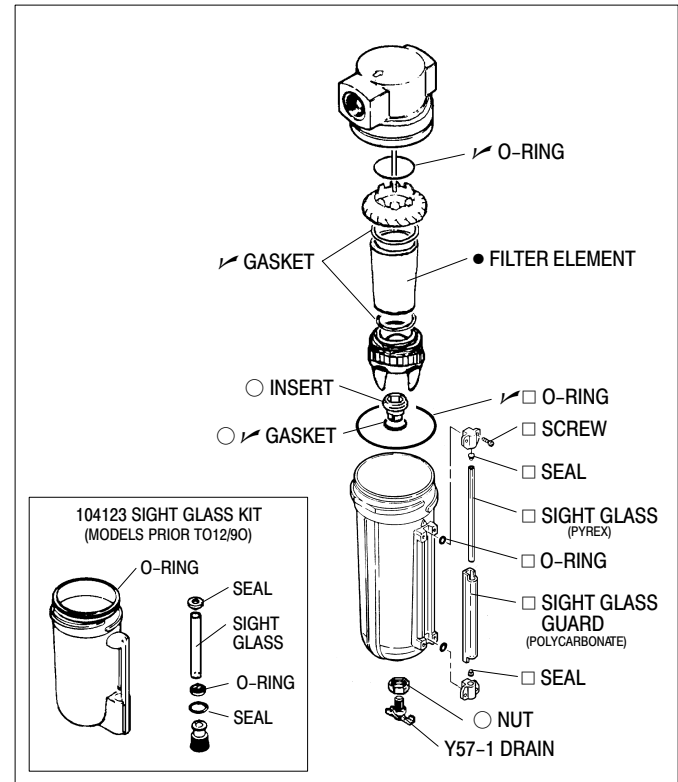

THE ARO CORPORATION • ONE ARO CENTER • BRYAN, OHIO 43506-0151

☎ (419) 636-4242 • FAX (419) 636-2115

©1994 THE ARO CORPORATION • PRINTED IN U.S.A.



Part of worldwide Ingersoll-Rand

264XX-XXX LUBRICATOR

PRIMARY PRESSURE

250 PSI MAX. (17.2 BAR MAX.)

TEMPERATURE RANGE

0° F to 175° F (-18° C to 79° C)

REPAIR KITS

- ✓ 104118 REPAIR KIT
- 104163 SIGHT GLASS KIT
- 104124 SIGHT DOME KIT
- 104212 DRAIN KIT
- 104213 SENSOR RETAINER ASM. (NOT SHOWN)

INSTALLATION

Install lubricator downstream from regulator and filter and as close as possible to the tool, cylinder, or pneumatic device. The lubricator must be installed with the air flow through the unit in the direction as indicated by the arrow on the base. All oil feed rate adjustments should be made with the unit in operation. To decrease oil feed rate, turn adjustment screw clockwise, and to increase oil feed rate, turn the adjustment screw counter-clockwise.

ACCESSORIES

104115 U-BOLT MTG. BRACKET KIT
(INCLUDES (2) "L" BRACKET & (2) U-BOLTS)

29235 PRESSURE FILL ADAPTER
(REPLACES Y57-1 DRAIN)

274XX-XXX REGULATOR

PRIMARY PRESSURE

300 PSI MAX. (20.7 BAR MAX.)

ADJUSTED PRESSURE

250 PSI MAX. (17.2 BAR MAX.)

TEMPERATURE RANGE

0° F to 175° F (-18° C to 79° C)

REPAIR KITS

- ✓ 104117 REPAIR KIT (RELIEVING)
- 104121 SPRING (5-125 #YELLOW - STANDARD)
- 104120 SPRING (5-50 #GREEN - OPTIONAL)
- 104122 SPRING (15-250 #BLACK - OPTIONAL)

INSTALLATION

Install the regulator upstream from the lubricator and as close as possible to the tool, cylinder, or pneumatic device. The regulator must be installed with the air flow through the unit in the direction as indicated by the arrow on the base. If the air line contains water, sludge, or foreign materials, an ARO Air line Filter should be installed on the upstream side to protect the regulator. After the regulator has been installed in the air line, the adjustment knob should be turned counter-clockwise until it stops, to prevent over-pressurizing the tool, cylinder, or pneumatic device when air supply is turned on.

ACCESSORIES

104114 PANEL NUT & BRACKET KIT
(INCLUDES (1) BRACKET & (1) PANEL MT. NUT)
100066 GAUGE (0-60#), 100067 GAUGE (0-160#), 100083 GAUGE (0-300#)

PN 103997

2752X-X

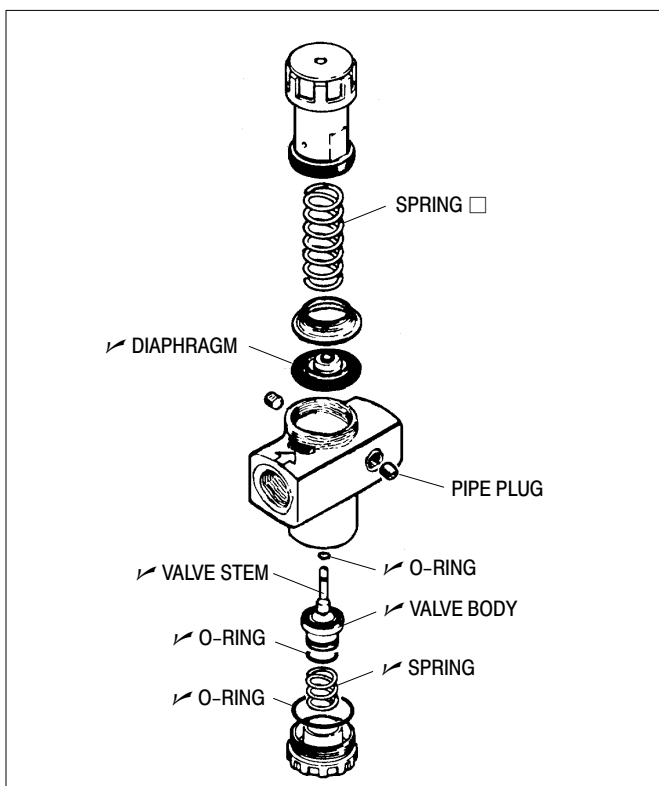
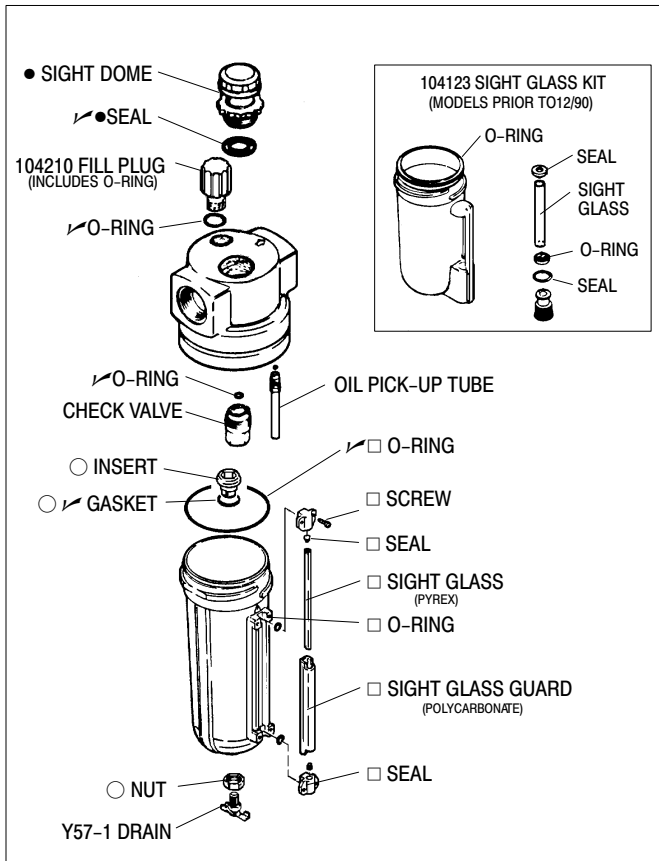

Part of worldwide Ingersoll-Rand